

Dust extractor

X09707

DUSTOMAT DRY 5800

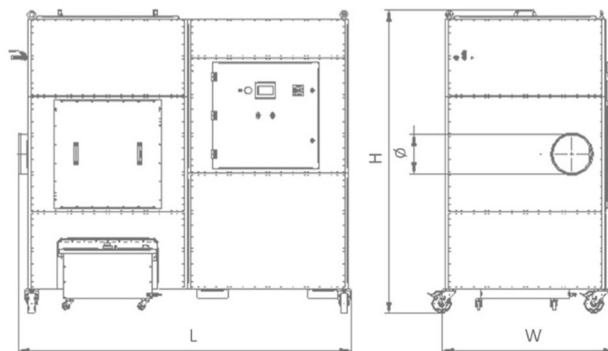

Technical data (Technical data and drawings may vary depending on the selected variant. Please refer to the type plate for the relevant values)

Mains voltage	400 V	Main filter surface	4 x 16.7 m ²
Nominal power	5.5 kW	Main filter quantity	4 pieces
Mains frequency	50 Hz	Collection volume	90 L
Nominal current	10.5 A	Dimensions (L x W x H)	2,120 x 1,110 x 2,170 mm
Circuit breaker	C32A	Weight	510 kg
Max. volume flow	5,800 m ³ /h	Type of cleaning	Jet-Pulse
Max. negative pressure	3,400 Pa	Compressed air consumption	4-6bar with valve opening time 0.12 sec
Sound pressure level [at nominal speed]	[dBA] 72	Compressed air connection	1/4"
Intake opening	Ø 315 mm		

Application range

- » For the single or multi-station extraction
- » For dry, free-flowing dusts as well as for chips (depending on the version, also for carcinogenic, flammable or explosive media)

Design

- » Housing material and material of parts in contact with the medium: Steel (S235JR)
- » Installation location: EX zone-free

Options

- » Mobile and stationary design
- » Air recirculation operation and air extraction operation
- » With automatically rotation filter cleaning system
- » With mechanical spark pre-separator
- » Filter type cartridge: PE, PTFE-Membran, PP (Oil / water repellent) optionally also in antistatic
- » With and without precoating
- » With post-filter: (H14) (Degree of separation >99,995%) or post-filter (F9)
- » With activated carbon filter to neutralise odours
- » With potential-free contact [On/Off] and (with round plug connector)
- » Housing material: V2A
- » Material of parts in contact with the medium: V2A
- » ATEX marking: Dust inside II 3D Ex h IIIC T140°C Dc X
Dust inside II 3D Ex h IIIB T140°C Dc X

Special Features

- » Particularly long filter life due to optimum ratio between air volume flow and filter surface as well as very effective filter cleaning.
- » High suction power ensures optimum extraction results at your collection point
- » Filter cleaning that is gentle on operating resources, thanks to the latest cleaning technologies
- » High separation efficiency of the filter media used ensures compliance with the required standards/directives.
- » The sound-insulated housing design and targeted air routing ensure low operating noise for quiet (continuous) operation.
- » Detachable/mobile dust collection container with large capacity ensures simple and quick removal or disposal of the separated material and reduces the number of disposal cycles. This minimises maintenance efforts as well as downtimes in the production process.

State of the art: This document was generated automatically. Technical changes reserved!