

NEW

360°-Extraction table



Rotatable extraction table for connection to an extraction system or a fan

The 360° extraction table is especially suitable for mechanical and thermal separation processes. The turning function of the table around its own axis allows users all-round access to their workpiece – which reduces time-consuming clamping processes.

Thanks to the optimised airflow and the flexible hood over the working area, the 360° extraction table effectively protects employees from dust and fumes. The ergonomically designed and, if desired, height-adjustable construction also ensures safe and pleasant working conditions.

Application range

- » For connection to a fan or extraction system
- » For grinding, welding and deburring of metal parts
- » Can be used for further applications

Your Benefits

- » More efficiency when machining workpieces
- » Time saving due to fewer transformer steps and process shortening due to shorter cycle times
- » Highest levels of ergonomics for employees
- » Less contamination of the workplace

Special Features

- » Folding side fairing (without hood)
- » Workpiece accessible from all sides (up to 360°)
- » Maximum workpiece width: 900 mm (with closed walls)
- » Height adjustment: 980 to 1.180 mm
- » Requires approx. 2.500 m³/h air volume
- » Suction nozzle in front area
- » Adjustable end stop

Special versions

- » Stepless electrical height adjustment (980 to 1.180 mm)
- » Grid or vice
- » Magnetic protection jaws
- » Lighting
- » Individual pedestal
- » ATEX compliant
- » Hood
- » Unit support



Suction nozzle in front area

Technical Data

360°-Extraction table		
Intake diameter	mm	250
Dimensions (L/W/H) without hood	mm	1.000 × 1.140 × 970
Dimensions (L/W/H) with hood	mm	1.000 × 1.400 × 970
Weight	kg	160
Order Number		44050

NEW

360°-Extraction table

Standard-Extraction Table



1st clamping

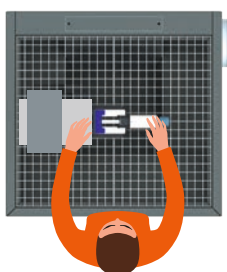

2nd clamping

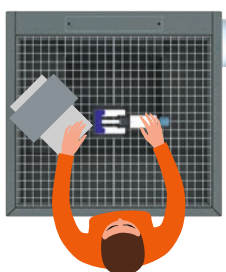

3rd clamping

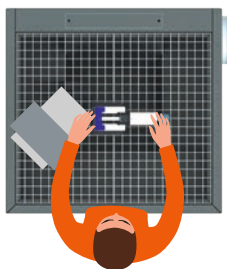

4st clamping

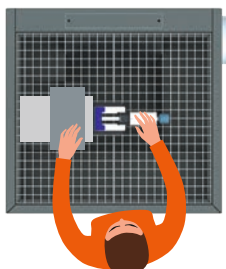

360°-Extraction Table



Only clamp once!

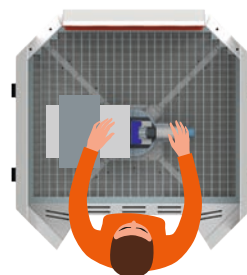
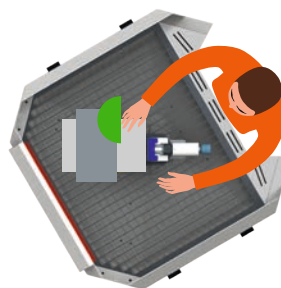
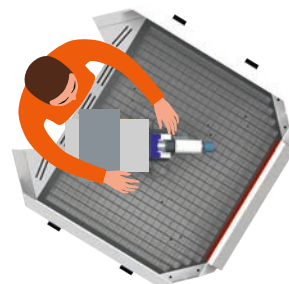
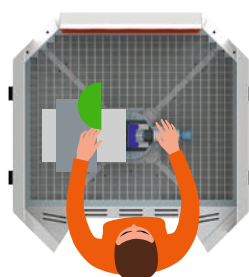

ESTA Apparatebau GmbH & Co. KG

Gotenstraße 2–6 · 89250 Senden/GERMANY

Phone +49 (0) 7307 3409680-0

Fax +49 (0) 7307 804-500

E-Mail export@esta.com

ESTA Extraction Technology

For over 45 years ESTA extraction technology has offered solutions for a multitude of industries and trades. From stand-alone units for the most diverse applications to complex extraction systems – we consistently ensure a clean working environment. ESTA equipment not only protects your high-tech machinery investments but also creates the prerequisites for highly efficient and quality oriented work results.

Contact us and request our complete catalogue free of charge.

www.esta.com

